

PLANO DE ESTACIONAMIENTO Y ATRAQUE DE AERONAVES/
AIRCRAFT PARKING/DOCKING CHART

ELEV AD 7 M

TWR	118.5
APP	119.0 / 121.3
RAMPA	134.1

PUERTO VALLARTA
AEROPUERTO INTL /
INTL AIRPORT
LIC GUSTAVO DIAZ ORDAZ

PLATAFORMA DE AVIACION COMERCIAL /
COMMERCIAL AVIATION APRON

- PSN 1: 64/R/A/W/T CONCRETO/CONCRETE
- PSN 2: 68/R/B/W/T CONCRETO/CONCRETE
- PSN 3: 70/R/A/W/T CONCRETO/CONCRETE
- PSN 4: 74/R/C/W/T CONCRETO/CONCRETE
- PSN 5-8: 55/R/B/W/T CONCRETO/CONCRETE
- PSN 9-12: 52/R/B/W/T CONCRETO/CONCRETE
- PSN 13-15: 76/R/B/W/T CONCRETO/CONCRETE
- PSN 16-18: 85/F/B/X/T ASFALTO / ASPHALT
- PSN 16-18: 62/R/B/W/T CONCRETO/CONCRETE
- PSN 19-20: 81/R/A/W/T CONCRETO/CONCRETE

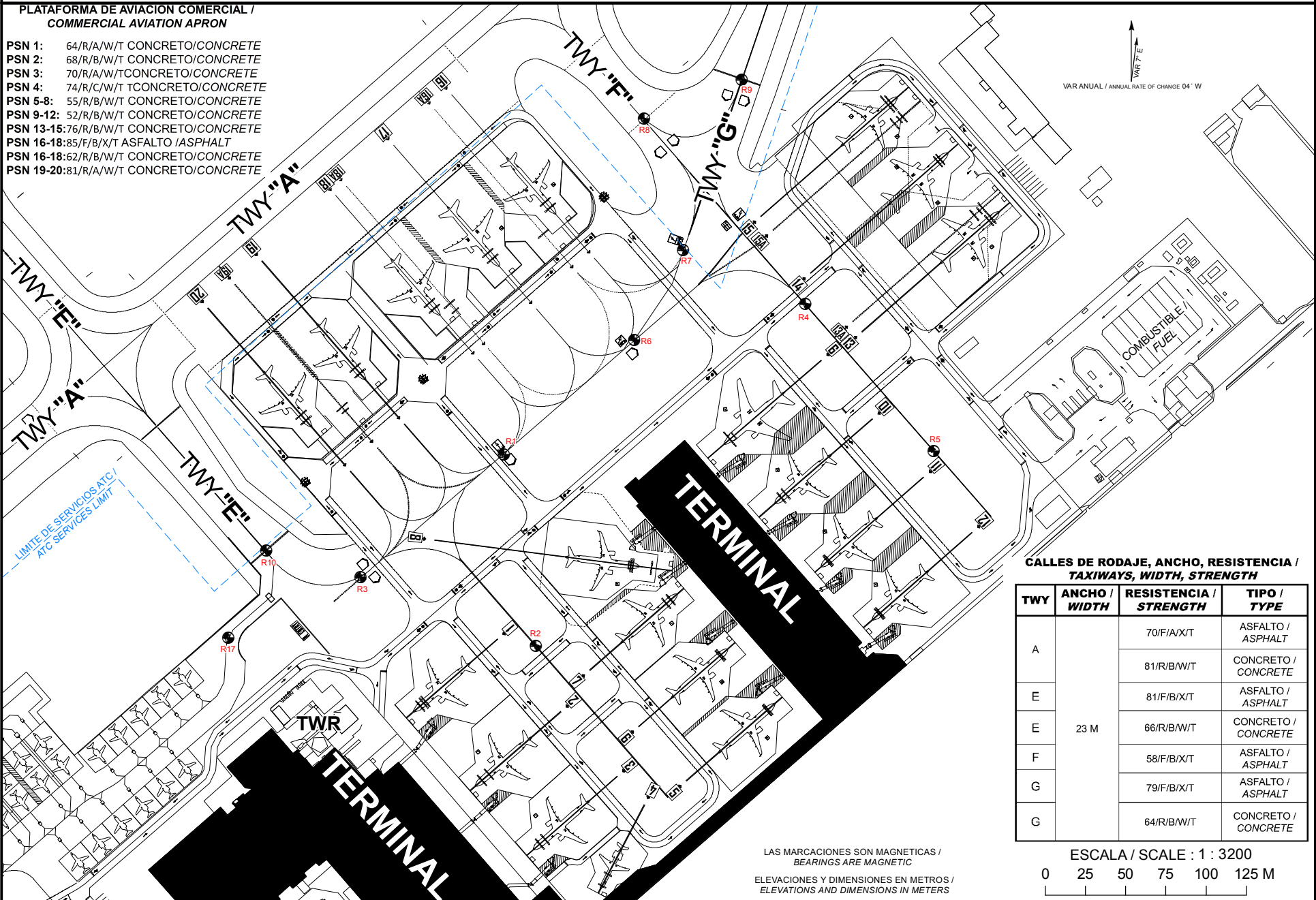

CALLES DE RODAJE, ANCHO, RESISTENCIA /
TAXIWAYS, WIDTH, STRENGTH

TWY	ANCHO / WIDTH	RESISTENCIA / STRENGTH	TIPO / TYPE
A	23 M	70/F/A/X/T	ASFALTO / ASPHALT
		81/R/B/W/T	CONCRETO / CONCRETE
E	23 M	81/F/B/X/T	ASFALTO / ASPHALT
E		66/R/B/W/T	CONCRETO / CONCRETE
F	23 M	58/F/B/X/T	ASFALTO / ASPHALT
G		79/F/B/X/T	ASFALTO / ASPHALT
G	23 M	64/R/B/W/T	CONCRETO / CONCRETE

LAS MARCACIONES SON MAGNETICAS /
BEARINGS ARE MAGNETIC

ELEVACIONES Y DIMENSIONES EN METROS /
ELEVATIONS AND DIMENSIONS IN METERS

ESCALA / SCALE : 1 : 3200

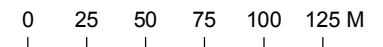

CAMBIOS: NIL

**COORDENADAS INS DE PUESTOS DE ESTACIONAMIENTO DE AERONAVES AVIACION COMERCIAL /
COORDINATES INS, FOR AIRCRAFT STANDS, COMMERCIAL AVIATION**

PSN	LAT (N)	LONG (W)	ACFT
1	20° 40' 45.32"	105° 14' 55.05"	
2	20° 40' 43.94"	105° 14' 53.69"	A-321-200W
3	20° 40' 42.71"	105° 14' 52.49"	
4	20° 40' 41.93"	105° 14' 51.17"	EMB-145
5	20° 40' 45.44"	105° 14' 47.87"	
6	20° 40' 46.47"	105° 14' 48.89"	A-321-200W
7	20° 40' 47.54"	105° 14' 49.93"	
8	20° 40' 48.18"	105° 14' 50.72"	A350-9
9	20° 40' 50.69"	105° 14' 48.81"	B-757-200W
10	20° 40' 49.58"	105° 14' 47.71"	
11	20° 40' 48.40"	105° 14' 46.69"	A-321-200W
12	20° 40' 47.40"	105° 14' 45.60"	
13	20° 40' 55.14"	105° 14' 43.54"	B-757-200
13A	20° 40' 55.34"	105° 14' 43.73"	A350-9
14	20° 40' 56.25"	105° 14' 44.64"	B-757-200
15A	20° 40' 57.01"	105° 14' 45.51"	B-787-9
15	20° 40' 57.33"	105° 14' 45.70"	
16	20° 40' 55.08"	105° 14' 52.67"	A-321-200W
16A	20° 40' 54.55"	105° 14' 52.78"	B-787-9
17	20° 40' 54.07"	105° 14' 53.84"	B-757-200
18A	20° 40' 53.01"	105° 14' 54.56"	B-767-300ERW
18	20° 40' 53.05"	105° 14' 55.01"	
19	20° 40' 51.76"	105° 14' 56.49"	A-321-200W
19A	20° 40' 51.02"	105° 14' 56.77"	A-350-9
20	20° 40' 50.81"	105° 14' 57.58"	A-321-200W

**COORDENADAS PUNTOS DE TRANSFERENCIA /
HAND OFF POINTS COORDINATES**

PSN	LAT (N)	LONG (W)
R1	20° 40' 50.26"	105° 14' 53.49"
R2	20° 40' 46.57"	105° 14' 52.69"
R3	20° 40' 47.79"	105° 14' 56.34"
R4	20° 40' 53.36"	105° 14' 47.33"
R5	20° 40' 50.61"	105° 14' 44.62"
R6	20° 40' 52.56"	105° 14' 50.84"
R7	20° 40' 54.35"	105° 14' 49.88"
R8	20° 40' 56.85"	105° 14' 50.79"
R9	20° 40' 57.71"	105° 14' 48.78"
R10	20° 40' 48.24"	105° 14' 58.33"
R17	20° 40' 46.52"	105° 14' 59.06"